

- **BE SURE TO REMOVE SHIPPING RODS PRIOR TO THE FIRST USE OF THE APPLIANCE. ATTEMPTING TO OPERATE THE MACHINE WITHOUT REMOVING THE SHIPPING RODS MAY RESULT IN IRREPARABLE DAMAGE WHICH IS NOT COVERED UNDER WARRANTY.**
- When connecting your washing machine to the water supply, be sure to use the brand new water inlet hose and appropriate sealing gaskets (included).
- Do not locate the machine in a room with temperature below 0°C. Parts of the machine may be damaged if frozen.
- Install the washing machine in a perfectly horizontal position, on solid flat concrete floor.
- Follow the instructions for correct installation and water and main connections.
- Never immerse the end of the drain hose into the draining water.
- Prior to starting the wash cycle, ensure the door is closed properly.
- Door may not be open during the washing cycle.
- Use only detergents and softeners for machine wash. Manufacturer may not assume responsibility for any damage and eventual discoloring of gaskets and plastic components as a consequence of incorrect use of bleach and/or coloring agents.
- High Efficiency (“HE”) detergent recommended.
- For removal of lime residues use such agents with added anti-corrosion agents. Follow the manufacturer’s instructions. Finish the lime removal by multiple rinsing completely remove eventual acid residues.
- Never use detergents containing solvents, since there is a danger of creating toxic gasses which may damage the machine and result in ignition or explosion.
- Upon completion of washing operation close the water faucet.

- Before any transport insert at least one shipping rod. Prior to this operation disconnect the appliance from the main power!
- Rating plate with basic information is located on the edge of the door opening.

**Before connecting the appliance read these instructions carefully. Repairing any failure arising from inappropriate connections or use of the appliance is not covered by the guarantee.**

**The symbol on the product or on its packaging indicates that this product may not be treated as household waste. Instead it shall be handed over to the applicable collection point for the recycling of electrical and electronic equipment. By ensuring this product is disposed of correctly, you will help prevent potential negative consequences for the environment and human health, which could otherwise be caused by inappropriate waste handling of this product. For more detailed information about recycling of this product, please contact your local city office, your household waste disposal service or the shop where you purchased the product.**

## Safety Instructions

**To reduce the risk of fire, electric shock, or injury when using your appliance, follow basic precautions, including the following:**

1. Read all instructions before using the appliance.
2. Do not wash articles that have been previously cleaned in, washed in, soaked in or spotted with gasoline, dry-cleaning solvents, and other flammable or explosive substances as they give off vapors that could ignite or explode.
3. Do not add gasoline, dry-cleaning solvents, or other flammable or explosive substances to the wash water. These substances give off vapors that could ignite or explode.
4. Under certain conditions, hydrogen gas may be produced in a hot water system that has not been used for 2 weeks or more. **HYDROGEN GAS IS EXPLOSIVE**, if the hot water system has not been used for such a period, before using a washing machine, turn on all hot water faucets and let the water flow from each for several minutes. This will release any accumulated hydrogen gas. As the gas is flammable do not smoke or use an open flame during this time.
5. Do not allow children to play on or in the appliance. Close supervision of children is necessary when the appliance is used near children.
6. Before the appliance is removed from service or discarded, remove the door.
7. Do not reach into the appliance if the tub or agitator is moving.
8. Do not install or store this appliance where it will be exposed to the weather.
9. Do not tamper with controls

10. To reduce the risk of electric shock, disconnect the appliance from the power supply before attempting any user maintenance. Turning the control to the »OFF« position does not disconnect the appliance from the power supply.

***Save these instructions*****Grounding instructions**

This appliance must be grounded. In the event of malfunction or breakdown, grounding will reduce the risk of electric shock by providing a path of least resistance for electric current. This appliance is equipped with a cord having an equipment-grounding conductor and a grounding plug. The plug must be plugged into an appropriate outlet that is properly installed and grounded in accordance with all local codes and ordinances.

**Improper connection of the equipment-grounding conductor can result in a risk of electric shock. Check with a qualified electrician or serviceman if you are in doubt as to whether the appliance is properly grounded.**

Do not modify the plug provided with the appliance-if it will not fit the outlet; have a proper outlet installed by a qualified electrician.

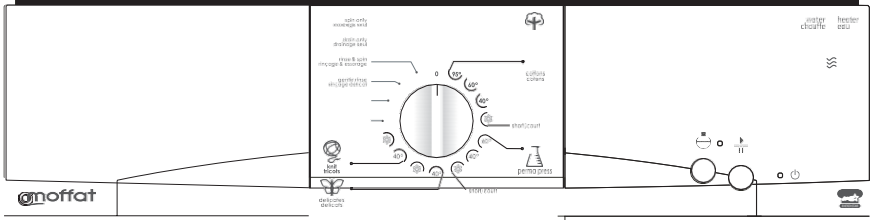

- A - program selector**
- B - rinse hold button**
- C - START/PAUSE button**

**Signal LED's:** - ON/OFF (orange)  
- rinse hold/failure (green)

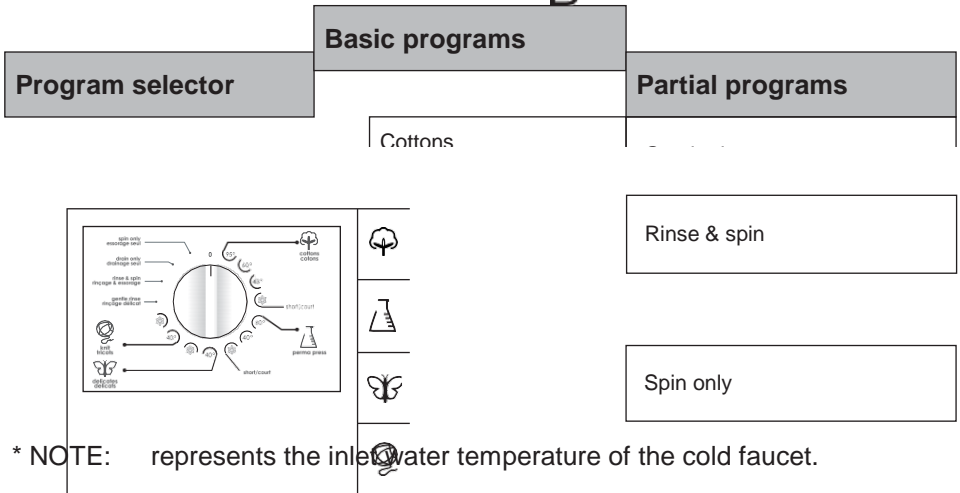

\* NOTE: represents the inlet water temperature of the cold faucet.

**Washing procedure**

- Open the door of the machine
- Load the laundry into the drum
- Close the door
- Open the water inlet faucet
- Push the ON/OFF button and select the program
- Add detergent (and softener) into dispenser. See page 16 for instructions about the dispenser.
- Start the operation by pushing the START button (C).

- **Open the door of the machine.**  
Door is opened by pulling the handle (lever) on the right hand side of the door towards you.
- **Sort the laundry by the type of fabric.**

**Fasten buttons and zippers, tie any strings and pull out the pockets.**

**Very delicate laundry should be put in a special protective sack.**

**It is recommended to load the drum with items of different sizes.**

**Pay attention to the labels on the clothes, indicating the recommended washing mode (see table of textile treatment symbols on the last page of these instructions).**

- **Load the laundry into the drum.**
- **Close the door of the appliance.**
- **Open the water inlet faucet.**
- **Push the ON/OFF button** and select washing program.

### ***Washing machine operation***

Program is selected by turning the program selector (A) from the "0" position to the desired washing program. The ON/OFF signal LED starts flashing. The program selector (A) may be turned in both directions. Choose the appropriate program according to the type of laundry and desired temperature. For example, cottons and 95°C (Refer to the Program Chart on page 27). You may select basic or partial programs. Selected program may be changed at random prior pushing the START button (C).

#### **- Selection of basic programs ( , , , )**

Basic programs include all washing stages, softening and spinning (see Program Chart). They are selected by turning the program selector to the appropriate

## Operating Instructions

### ***Cottons: whites/colored***

Normally stained cotton: bed linen and underwear, table cloth, bathroom towels, top garments, etc.

For less stained laundry of this type, select a cooler wash temperature. It saves energy and washing time.

### ***Perma press***

Normally stained shirts, blouses and other polyester and polyamide garments, or a mixture of these fabrics with cotton.

For less stained laundry of this type, select a cooler wash temperature. It saves energy and washing time.

### ***Delicates***

This is a program for delicate fabrics (dresses, skirts, blouses) and curtains.

### ***Knit***

Especially gentle program for washing wool and garments made from mixture of other fabrics with wool, appropriately marked for machine washing.

## **Selection of additional function**

### ***Rinse hold***

This option allows you to leave the laundry soaking in case you are not able to remove the laundry directly after the cycle. This prevents creasing.

- The wash cycle stops just before the last spin cycle.
- This function can be selected after the selection of a basic program by pressing the button (B). It may also be switched on during the wash cycle, before the last rinse. Indicator LED above the washing cycle symbol is lit when this option is selected.
- The function is switched off by pressing the same button again - signal LED is off.

- The selected program is completed by pushing the START button (C). You may also apply partial programs (drain or spin only), by first returning the program selector to the “0” position for at least one second, then selecting any of the additional programs.
- When program continues, indicator LED above the knob turns off.

### **Selection of partial programs**

These are independent programs and may be used when you do not need the entire washing program. In case you would like to use more additional programs in a sequence, you must turn off the appliance prior to any new program selection (turn the program selector (A) to “0” for at least one second). Refer to Program Chart page 27.

#### ***Gentle***

Independent program for rinsing delicate laundry, without intermediate spinning and with short final spin. You may use it for rinsing manually washed delicate laundry or for extra rinsing for people with skin sensitive to detergents.

#### ***Rinse & spin***

This program is intended for softening or bleaching washed laundry. It finishes with spinning at 1000 RPM.

#### ***Drain only***

Use it when the washing program was interrupted or if rinse hold function was engaged, and you only wish to pump the water out of the drum, without spinning.



#### ***Spin only***

Aggressive spinning for non-delicate laundry at high spin RPM.

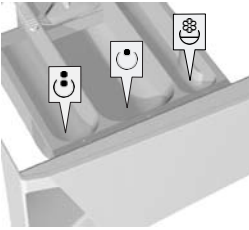





**- Adding detergent and fabric softener**  
(see Tips for washing and energy saving)

- pre-wash compartment 
- main wash compartment 
- softener compartment 

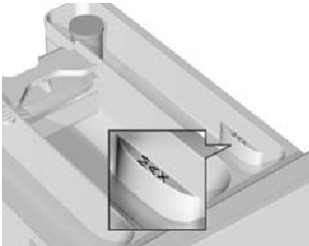
Washing detergent may be added directly into the drum.



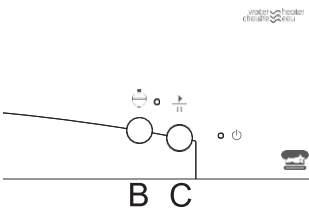

-  **When adding softener, be careful to fill the dispenser only up to the marked level.**
-  **Be sure to close the detergent dispenser when opening/closing the appliance door.**

***Start the operation***

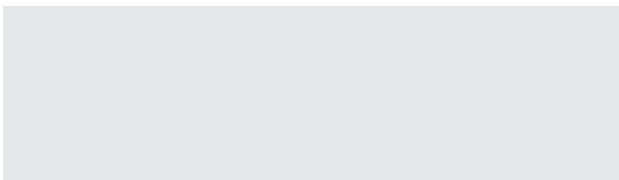

- Push the START button (C). The ON/OFF LED stops flashing, the machine starts operating after a few seconds. If the door is not properly closed after starting the operation, the ON/OFF LED starts flashing again after a few seconds. When you close the door, the machine initiates the selected program.
- In case you would like to alter the washing program after the initiated washing operation, turn the program selector for one second to the position "0", followed by the selection of a new program. Switching the machine off deletes any previously selected additional functions (i.e. RINSE HOLD) , so they have to be reactivated.



 **If a power failure occurs during the washing program, when the power is restored the machine will resume the execution of a program where it had been interrupted.**

**- End of operation**

Flashing START/STOP LED indicates that the program was completed.

- Extract the laundry from the drum and remove any foreign objects from the door gasket.
- Leave the door ajar to allow the interior to dry.
- Close the water inlet faucet.

**SWITCH THE MACHINE OFF BY  
DISCONNECTING THE APPLIANCE FROM  
MAINS SUPPLY.**

## Interruptions

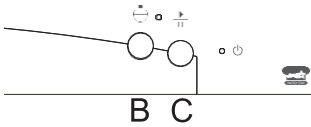

### By the user

#### Selecting Rinse Hold function

Program is stopped when it comes to the 'RINSE HOLD' stage (if this function had been previously selected). Drum door remains closed all the time. Indicator LED above the 'Rinse hold' function starts flashing. Washing procedure is continued by pressing the START button (C).

#### Own (physical) interruption

You may also stop the program by turning the program selector to the position "0". If there is water in the drum select one of additional programs (draining, spinning) to empty the water and terminate the program.

#### Pause button

By pressing the PAUSE button, (C) the program may be suspended at any time. After certain time you may open the door if there is no water in the drum, otherwise this is not possible. Program is continued by pressing the START button (C).

#### ● Failures

Program is suspended in case a failure occurs. Signal LED's are flashing (see Troubleshooting).

#### ● Power failure

At electric cutout the program is interrupted, however, after the power supply has been re-established, the program operation automatically proceeds.

**If a power failure occurs when the drum is still full of water, be careful not to open the door before you drain the water out.**

## Cleaning and maintenance

**Disconnect the washing machine from the main power supply before cleaning!**

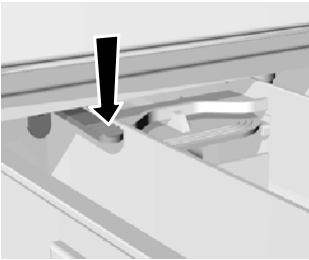

- The cabinet should be cleaned with soft cloth and mild detergent.
- The interior of the drum and the door gasket is cleaned by washing at 140°F (60°C) without laundry and adding half quantity of detergent.
- If necessary, clean the detergent dispenser. Pull it out from its casing completely by pressing the flap (see Fig.).
- If necessary, clean the cover of the bung under running water.

Wash it under running water using a brush, and dry it. Remove any leftover dried detergent from the bottom of the casing.

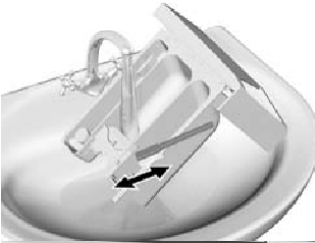

- Clean the entire rinsing area of the washing machine with a brush, especially the nozzles on the upper side of the rinsing chamber.

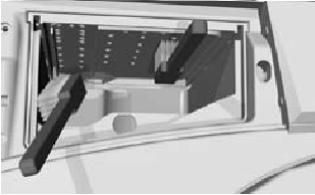

- Clean the water inlet hose screen under running water regularly.
- After each wash wipe the door rubber gasket. This will prolong its useful life.



- Open the filter lid using flat screwdriver or similar tool.

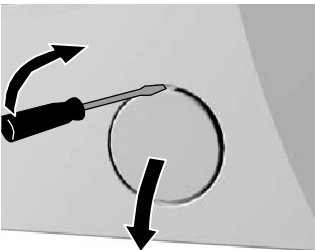

Filter needs occasional cleaning, especially following heavily shaggy or old laundry.



- Before cleaning, drain any water from the machine via drain pipe (certain models only).



- Turn it counter-clockwise, pull it out and clean under running water.



- Insert the filter back as shown on the picture (arrow and pointer), and tighten by turning it in clockwise direction. To ensure good sealing the gasket surface (A) must be dirt free.

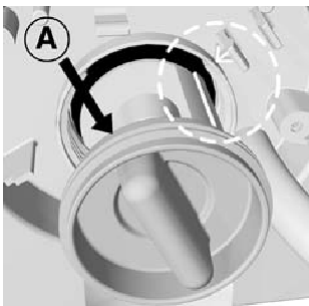

The washing machine automatically monitors the execution of particular functions during the operation, and reports any detected failures. In such cases both signal LED's start flashing in certain sequence. Flashing sequence changes in accordance with the nature of the detected failure. In some cases you may attempt correcting certain failures yourself, so count the number of flashes which repeat after a pause.

- The machine signals failures immediately after detecting them and stops the program, except for heater failure, where the machine completes the washing program without heating water.

**Failures:**

In certain cases you may remove the failure yourself (Refer to chart on page 25):

- 2 - two flashes: door is not correctly closed; 3 - three flashes: water inlet problem;
- 7 - seven flashes: water outlet problem.

In all other instances mark the number of flashes indicating the failure, switch off the machine and call nearest authorized service center (LED's continue flashing until you switch the machine off).

Environmental interference (for example electrical wiring) could induce signalization of different faults. In such cases:

- switch the appliance off, and wait for a few

Failure	Possible cause	Remedy
The machine does not work (symbols are not illuminated).	Machine is not powered.	Check if: <ul style="list-style-type: none"> <li>• power in the socket,</li> <li>• the fuse is OK,</li> <li>• plug is in the socket.</li> </ul>
Washing program does not start (ON/OFF LED is flashing).	Door is not properly closed.	Close door firmly.
Water does not enter the machine (after approx. 8 min the machine reports failure -3 flashes).	Water inlet failure.	Check if: <ul style="list-style-type: none"> <li>• the water faucet is open,</li> <li>• inlet hose screen filter is clean.</li> </ul> Push the START button.
Water is leaking from the machine.	Filter is not tightly screwed in. Inlet pipe is not tightly screwed to the machine or to the water faucet. Outlet hose fell to the floor.	Tighten the filter properly. Tighten the inlet pipe.  Affix the outlet pipe to the drain.

<p>The machine moves during operation.</p>	<p>The machine is not properly leveled. Transport brackets and shipping rods are not removed.</p>	<p>Level the machine with the adjustable legs. Remove transport brackets and shipping rods.</p>
<p>The machine vibrates during the spin.</p>	<p>Unevenly distributed laundry, especially with very small quantities (for ex. only the bathrobe).</p>	<p>This is normal, the machine will reduce the RPM if vibrations are too strong. Wash larger quantity of laundry.</p>
<p>Excessive foaming during washing.</p>	<p>Excessive measure of detergent.</p>	<p>Use detergent according to the instructions by the producer and according to the water hardness and soiled laundry. Use only detergents</p> <ul style="list-style-type: none"> <li>• for machine washing</li> <li>• use "HE" detergent.</li> </ul>
<p>Water is poorly pumped out or not at all (machine reports failure - seven flashes of LED).</p>	<p>Water outlet is clogged.</p>	<p>Check if:</p> <ul style="list-style-type: none"> <li>• the filter is clean,</li> <li>• outlet hose is not jammed,</li> <li>• outlet hose is positioned higher than 1m.</li> </ul> <p>Push START again.</p>
<p>Laundry is not properly spun. No failure is reported.</p>	<p>The machine switched on the UKS function. Because of bad laundry balance, the machine has automatically reduced spin RPM.</p>	<p>The machine operates normally. Wash large and small pieces of laundry together.</p>
<p>Greasy wads appear on the laundry.</p>	<p>Too little detergent (laundry was very greasy).</p>	<p>Wash the laundry again. Add more detergent for such soiled laundry, or use liquid detergent.</p>



**Failure**

Laundry is stained after washing.

White powdery residues on the laundry.

Detergent residues in the dispenser.

Softener is not completely rinsed, or water is left in the dispenser dish.

Washing time is longer than usual.

**Possible cause**

You used liquid detergent or detergent for colored laundry which does not contain whitener.

It is not the consequence of bad rinsing, but because of neo-phosphate detergents containing non soluble components (zeolites) for water softening. Such substances may be deposited upon the laundry.

Low water flow pressure. Some detergents may stick to the dispenser rather hard if it is wet.

Syphon cover is not correctly positioned or is clogged.

- The machine switched on the UKS\* system because of uneven laundry load.
- Power failure occurred.

**Remedy**

Use the detergent containing whitener.

- Immediately rinse the laundry once again.
- Use liquid detergents which do not contain zeolites.
  - Try removing the residues with the brush.

- Clean the inlet hose filter screen.
- In case of low water pressure increase water level.
- Wipe the dispenser prior loading detergent.

Clean the dispenser and firmly fix the cover to its place.

- Washing program time may be prolonged for 10 minutes and the machine still functions perfectly. Time is prolonged for the power failure period.

\* UKS: universal stability control - this function prevents excessive vibrations during s

